

# INSTRUCTIONS FOR TRANSPORT OF ROUTINE BLOOD SCIENCES AND MICROBIOLOGY SAMPLES

Biochemistry, Haematology and Immunology. e-record or ICE samples only, paper requests should be sent via normal routes.

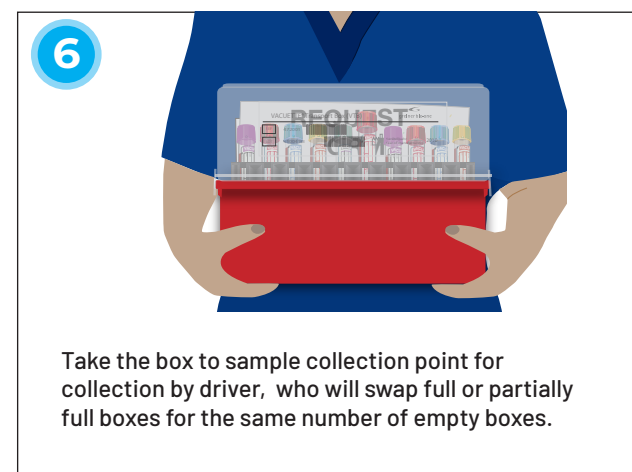
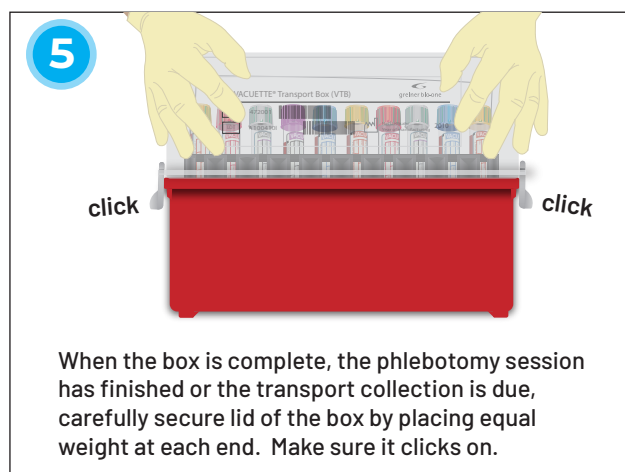
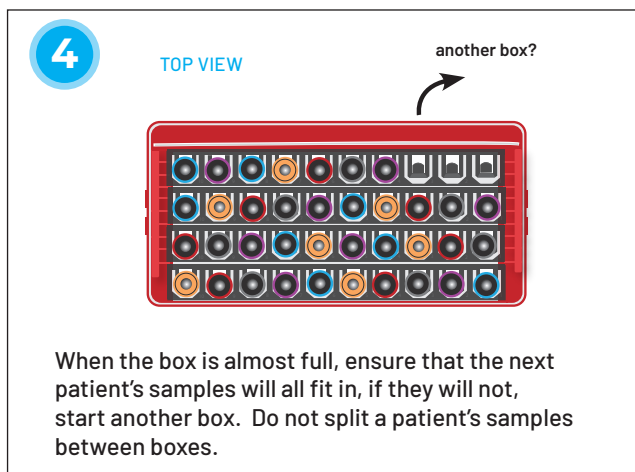
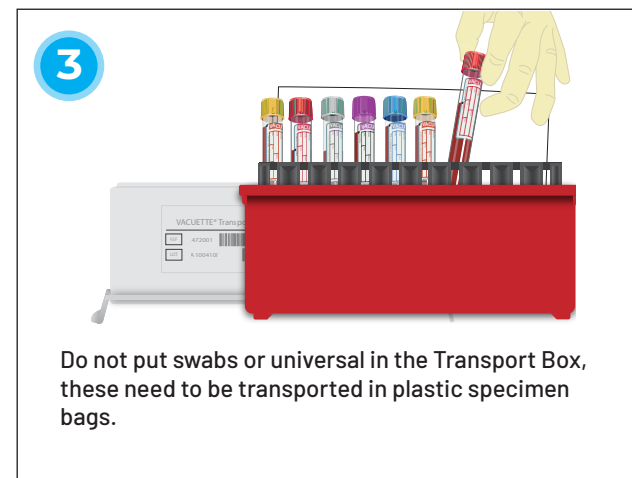
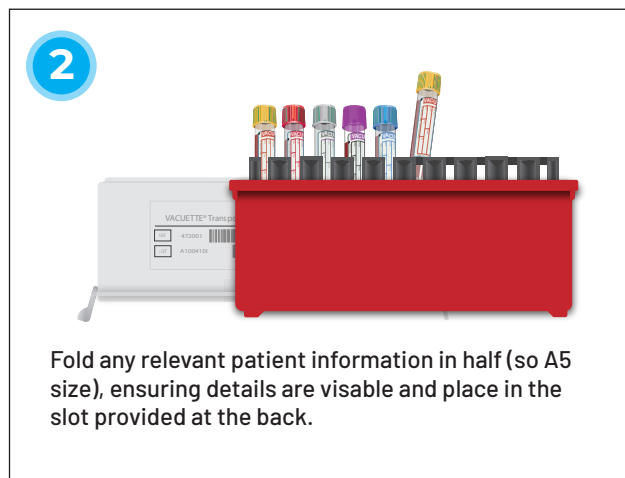
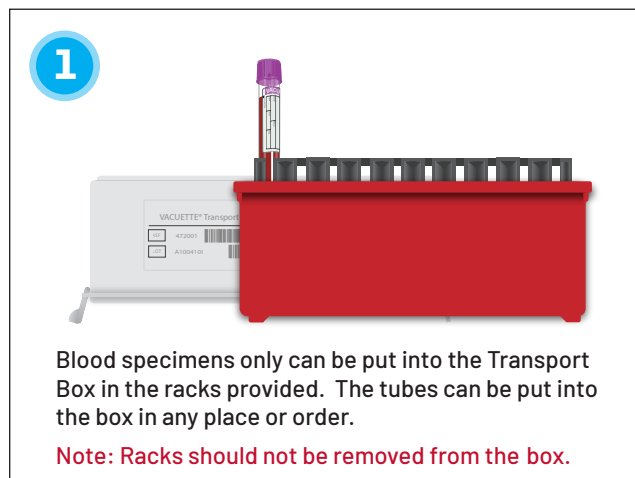

- **Tube racks must remain in place - DO NOT REMOVE**
- **Blood Specimens Only - DO NOT PUT SWABS OR UNIVERSAL TUBES IN THIS BOX**
- **Do not put samples which are to be transported on ice, or blood gases in this box**
- **Ensure the VACUETTE® Transport Boxes are closed and ready for the courier to collect**